

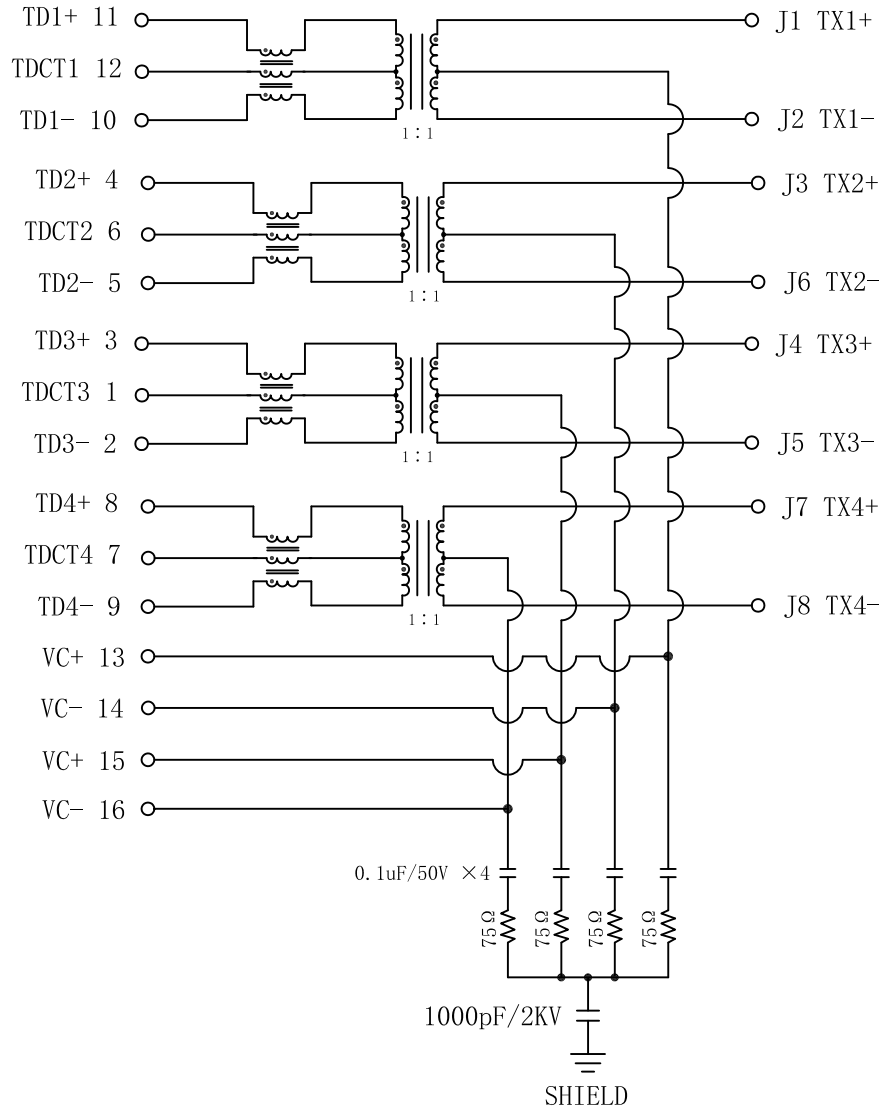

# Schematic:

| REV. | ECN NO. | DESCRIPTION | DATE      | APPD |
|------|---------|-------------|-----------|------|
| A    | REL     |             | 2015-7-11 |      |

PC BOARD CONNECTIONS



RJ45 CONNECTOR

## Electrical Specifications @25°C

- Inductance: 350uH Min  
@ 100KHz, 0.1V, 8mA DC BIAS
- Turns Ratio( $\pm 3\%$ ):  
Pri:Sec = 1CT:1CT
- Insertion Loss:  
1-100MHz:-1.1dB Max
- Return Loss:  
1-40MHz:-18dB Min  
60MHz:-14dB Min  
80MHz:-12dB Min  
100MHz:-10dB Min
- Crosstalk:  
1-100MHz:-35dB Typ
- Common Mode Rejection:  
0.1-30MHz:-38dB Typ  
30-60MHz:-35dB Typ  
60-100MHz:-30dB Typ
- Designed for PoE applications with  
maximum current of 350mA per pair
- Hipot: 1500Vrms Min
- Operating Temperature: 0°C~70°C.



|        |               |            |  |                      |
|--------|---------------|------------|--|----------------------|
| X:X    | $\pm 0.25$    | APPD:      | <b>Trxcom</b><br>Huizhou Trxcom Electronics Co.,Ltd.                               |                      |
| X:XX   | $\pm 0.20$    | CHKD:      |  |                      |
| X:XXX  | $\pm 0.05$    | DR: SEA    | TITLE: RJ45 Connector with 1000 Base-T<br>Integrated Magnetics For PoE Application |                      |
| ANGLES | $\pm 1^\circ$ | UNIT: mm   | PART NO.: TRJK2072CNL  |                      |
|        | SCALE: 2/1    | SHEET: 2/4 | REV: A   | DWG NO.: TRC15071129 |

# Profile of wave solder:

| REV. | ECN NO. | DESCRIPTION | DATE      | APPD |
|------|---------|-------------|-----------|------|
| A    | REL     |             | 2015-7-11 |      |

## SUGGESTED PROFILE OF WAVE SOLDER FOR ROHS PRODUCT

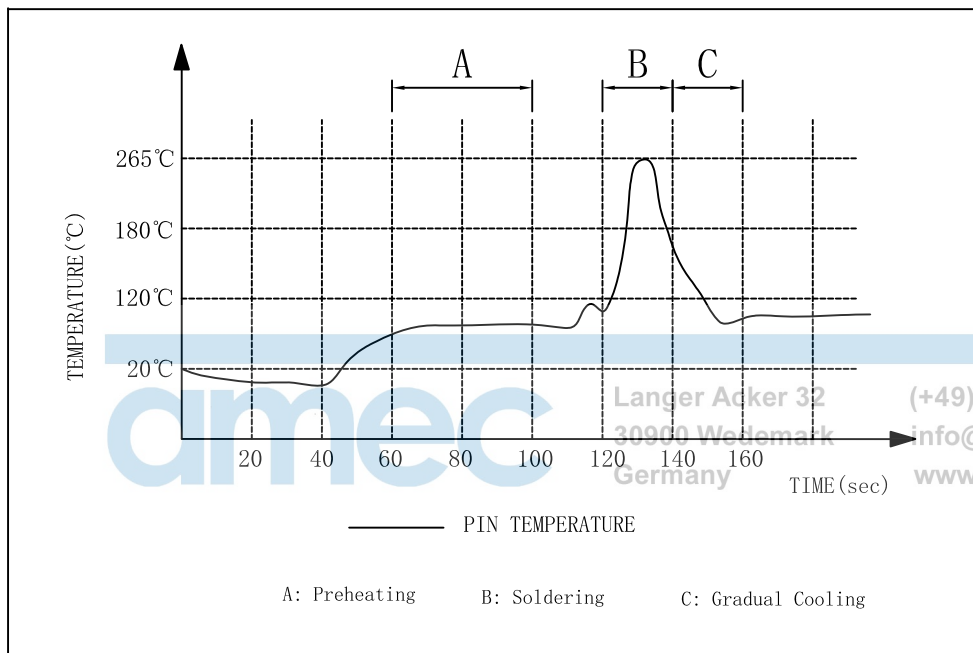

- (1) Tip Temperature: 265°C max
  - (2) Tip Temperature time: 5sec max
- Note: The melting point of Tin: 219°C

|             |            |  |
|-------------|------------|--|
| X:X ±0.25   | APPD:      | <b>Trxcom</b>  |
| X:XX ±0.20  | CHKD:      |  |
| X:XXX ±0.05 | DR: SEA    | TITLE: RJ45 Connector with 1000 Base-T<br>Integrated Magnetics For PoE Application |
| ANGLES ±1°  | UNIT: mm   | PART NO.: TRJK2072CNL  |
|             | SCALE: 2/1 | SHEET: 3/4   |
|             | REV: A     | DWG NO.: TRC15071129   |

Packaging:

| REV. | ECN NO. | DESCRIPTION | DATE      | APPD |
|------|---------|-------------|-----------|------|
| A    | REL     |             | 2015-7-11 |      |

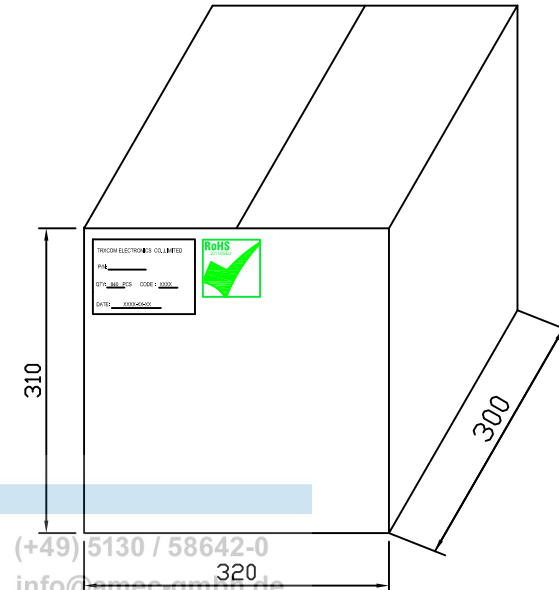
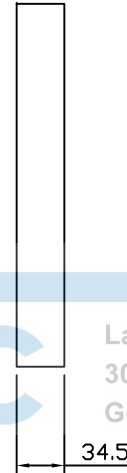
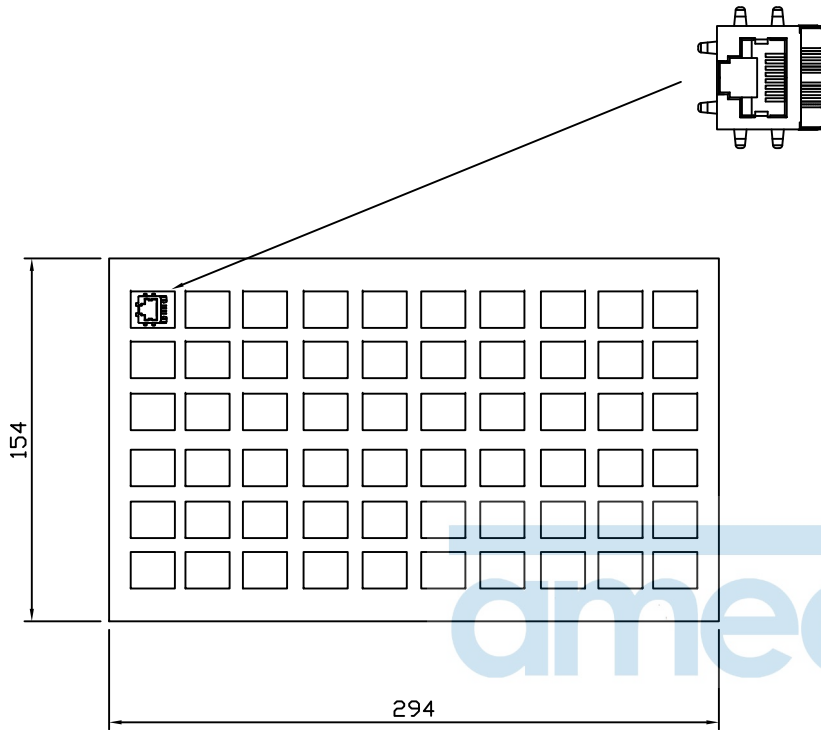

Langer Acker 32  
30900 Wedemark  
Germany

(+49) 5130 / 58642-0  
info@amec-gmbh.de  
www.amec-gmbh.de

- ◆ Packaging unit :60pcs/tray
- ◆ Packaging material:PVC
- ◆ Outer carton unit:840pcs/14tray/box
- ◆ Net Weight:7kg
- ◆ Gross Weight:9kg

|        |            |            |  |
|--------|------------|------------|--|
| X:X    | ±0.25      | APPD:      | <b>Trxcom</b><br>Huizhou Trxcom Electronics Co.,Ltd.                               |
| X:XX   | ±0.20      | CHKD:      |  |
| X:XXX  | ±0.05      | DR: SEA    |  |
| ANGLES | ±1°        | UNIT: mm   | TITLE: RJ45 Connector with 1000 Base-T<br>Integrated Magnetics For PoE Application |
|        |            | PART NO. : | TRJK2072CNL  |
|        | SCALE: 2/1 | SHEET: 4/4 | REV: A   |
|        |            | DWG NO. :  | TRC15071129  |